



SC TOPAZ

CREW TRANSFER VESSEL

 TYPE CATAMARAN	 CAPACITY 12 PAX	 FUEL LTR/HR 280 LTR	 LENGTH 21.6 M	 SHIP-TO-SHIP ALL SIDES	 SPEED 25 KTS
---	--	--	--	---	---

SIMA CHARTERS DISTINGUISHES ITSELF WITH ITS 'NO-NONSENSE' APPROACH AND 'HANDS-ON' MENTALITY. EXPERIENCED IN TENDERSERVICES AND OFFSHORE PROJECTS IS COMBINED IN THE MISSION TO OPTIMIZE PERFORMANCE. WE ALWAYS AIM TO PROVIDE THE BEST POSSIBLE SOLUTION.

GENERAL SPECIFICATIONS

Year	2013
Class/flag	CAT A, 200 NM / NL FLAG
Length o.a	21.58 m
Beam o.a	7.00 m
Minimum draft	1.10 m
Weight	45 T
Loading capacity	7 T
Max speed	25 kts @ 280 ltr/h
Fuel consumption per 12 hours	550 liter (based on projects 20NM offshore)

Callsign	PEFY
Official Number	26233 Z 2022
MMSI	244094000
Engines	2 x 860 HP / 662 kW
Aux engine	1 x 16 kW
Propulsion	2 x WATERJETS
Characteristics	High pressure pump, MOB unit, removable pax / storage unit



OUTSTANDING CTV SERVICES

MAXIMISING SAFETY AND COMFORT FOR CREW AND CARGO



SIMA CHARTERS IS A WORLDWIDE OPERATING OFFSHORE CTV COMPANY, PROVIDING THE BEST POSSIBLE CREW TENDER VESSELS, DESIGNED TO PERFORM. WITH PURPOSE BUILT, TOP-NOTCH VESSELS, SIMA CHARTERS PROVIDE THE SAFEST AND MOST COMFORTABLE RIDE AT SEA.

- // Fast crew transfer vessels
- // Up to 24 passengers per vessel
- // Also suitable for supplies and spare parts
- // Gyro stabilizations systems
- // Special monohull designs
- // Type specific MOB recovery systems
- // Fuel efficient, low CO₂ footprint
- // Navigation & communication systems according the Class regulations
- // ISM and ISO certified by Lloyds Register
- // Personnel are trained and familiarized according the high QHSE procedures

For more information please do not hesitate to contact us, we'd love to get in touch.

GENERAL ARRANGEMENT SC TOPAZ

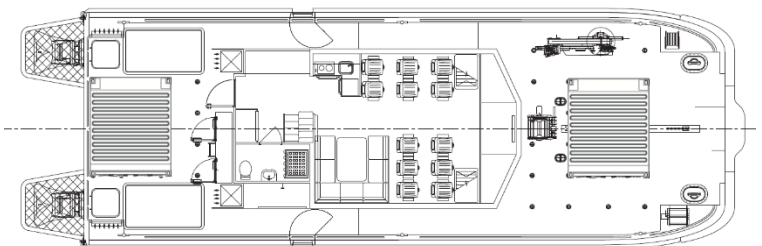
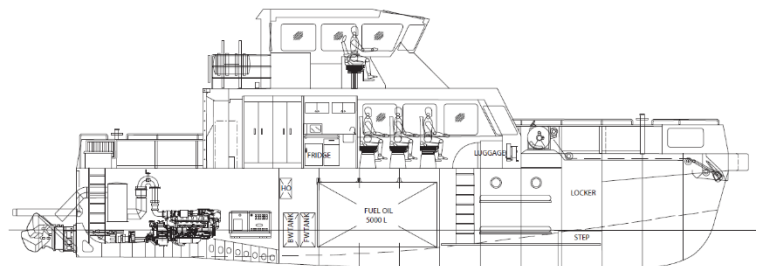

- ☎ +31 10 434 63 87
- ☎ commercial@simacharters.com
- ☎ WWW.SIMACHARTERS.COM



SIMA CHARTERS
crew- pilot & survey vessels