



SC MACAW

CREW - PILOT & SURVEY VESSEL



TYPE

CATAMARAN



CAPACITY

6 PAX



FUEL LTR/HR

70 LTR



LENGTH

13.75 M



SHIP-TO-SHIP

LIMITED



SPEED

25 KTS

SIMA CHARTERS DISTINGUISHES ITSELF IN THE MARKET WITH ITS 'NO-NONSENSE' APPROACH AND 'HANDS-ON' MENTALITY. EXPERIENCE IN LOCAL TENDERSERVICES AND OFFSHORE PROJECTS IS COMBINED IN THE MISSION TO MAXIMISE PERFORMANCE. WE ALWAYS AIM TO PROVIDE THE BEST POSSIBLE AND SOLUTION. THIS GOES AS FAR AS MODIFYING THE CURRENT FLEET OR EVEN BUILDING ANOTHER CUSTOM-MADE VESSEL.

GENERAL SPECIFICATIONS

| | | | |
|-------------------------------|---|-----------------|--|
| Year | 2011, full refit 2015 | Callsign | MCLW6 |
| Class/flag | MCA cat 2 60 NM / UK flag | Official Number | 922901 |
| Length o.a | 13,75 m | MMSI | 232013499 |
| Beam o.a | 5,35 m | Engine's | 2 x 483 HP / 355 kw |
| Minimum draft | 0,8 m | Aux engine | N/A |
| Weight | 20 T | Propulsion | 2 x Waterjets |
| Loading capacity | 0,5 T | Characteristics | 6 pax,survey vessel,accommodation, 2 crew cabins, extreme shallow draught, ship 2 ship |
| Max speed | 25 kts @ 180 ltr/h | | |
| Fuel consumption per 12 hours | 500 liter (based on projects 20NM offshore) | | |

OUTSTANDING CTV SERVICES

MAXIMISING SAFETY AND COMFORT FOR CREW AND CARGO



SIMA CHARTERS IS A WORLDWIDE OPERATING OFFSHORE CTV COMPANY, PROVIDING THE BEST POSSIBLE CREW TENDER VESSELS, DESIGNED TO PERFORM. WITH PURPOSE BUILT, TOP-NOTCH VESSELS, SIMA CHARTERS PROVIDE THE SAFEST AND MOST COMFORTABLE RIDE AT SEA.

- // Fast crew transfer vessels
- // Up to 12 passengers per vessel
- // Also suitable for supplies and spare parts
- // Gyro stabilizations systems
- // Special monohull design
- // Type specific MOB recovery systems
- // Fuel efficient, low CO₂ footprint
- // Navigation & communication systems according the Class regulations
- // ISM and ISO certified by Lloyds Register
- // Personnel are trained and familiarized according the high QHSE procedures

For more information please do not hesitate to contact us, we'd love to get in touch.

GENERAL ARRANGEMENT SC MACAW

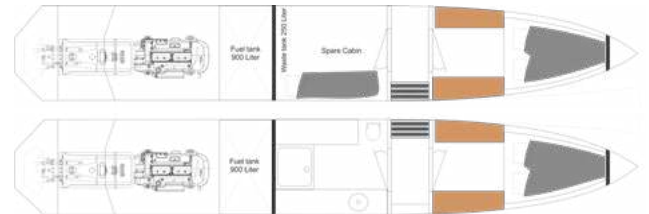
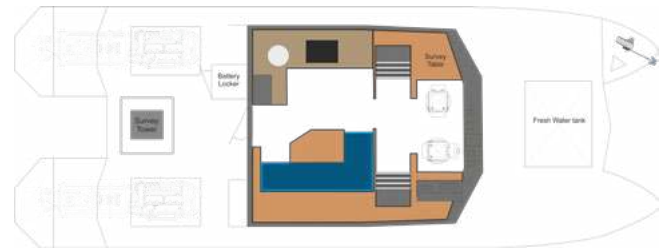

SIMA CHARTERS
crew- pilot & survey vessels

+31 10 434 63 87 // commercial@simacharters.com // www.simacharters.com
Burgemeester de Jonghskade 19 // 3143 CB Maassluis // The Netherlands